

**ESTRATTO CATASTALE
FG 7 MAPPALE 194
scala 1:1000**

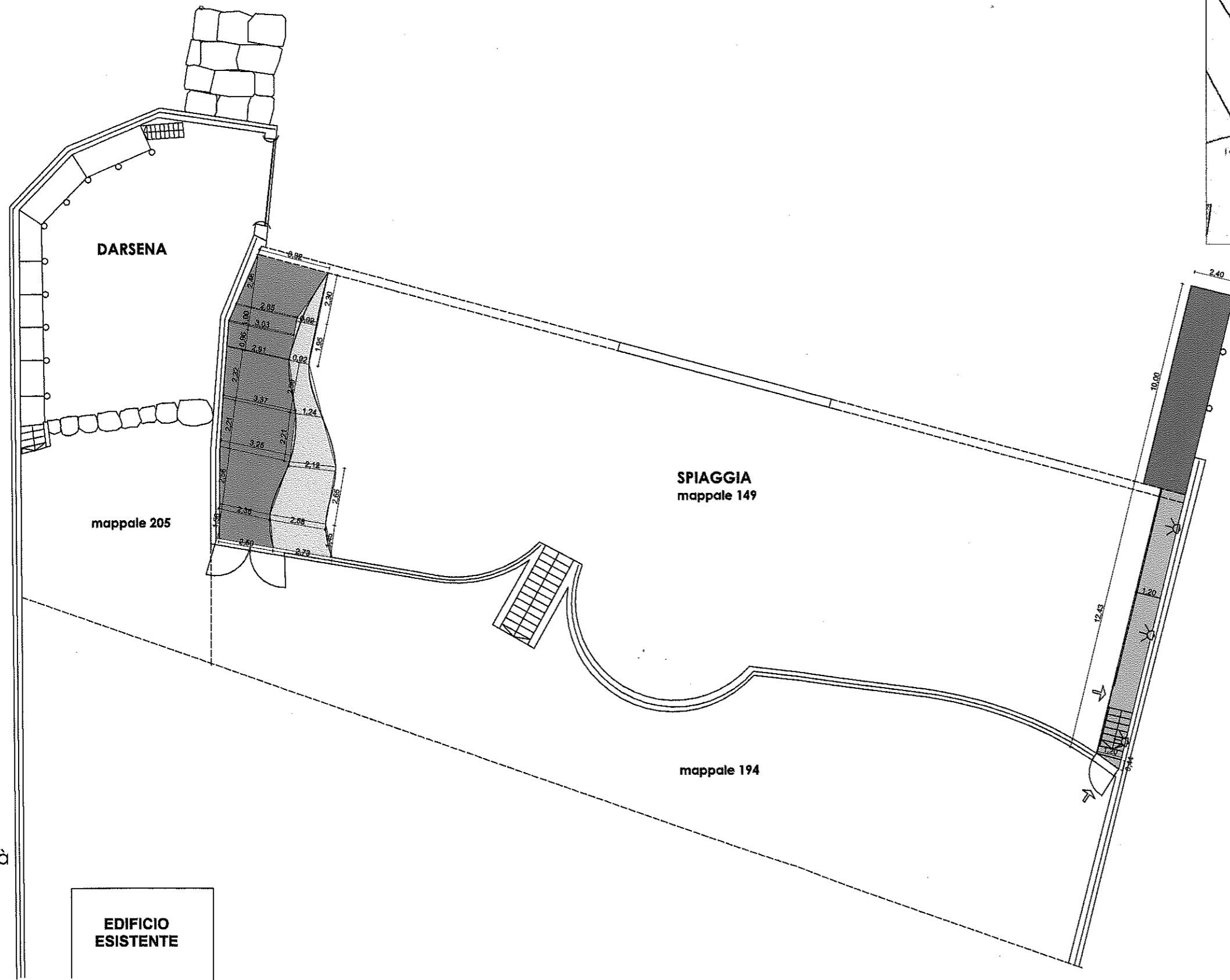
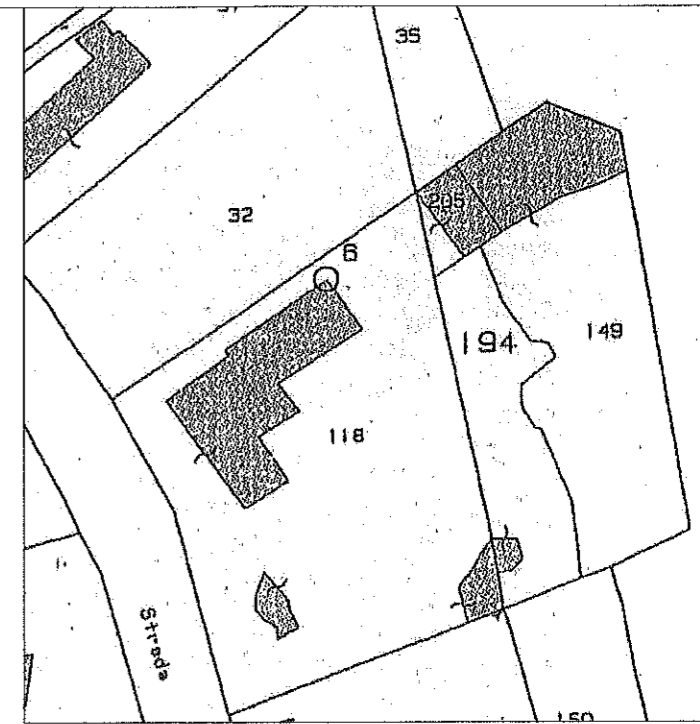

CALCOLI PLANIMETRICI

	$(2,50 \times 2,36) \times 1,56 / 2 = 3,79 \text{mq}$
	$(2,36 + 3,25) \times 2,56 / 2 = 6,19 \text{mq}$
	$(3,25 + 3,37) \times 2,21 = 7,31 \text{mq}$
	$(3,37 + 2,91) \times 2,32 = 7,28 \text{mq}$
	$(2,91 + 3,03) \times 0,96 = 2,76 \text{mq}$
	$(3,03 + 2,85) \times 1,00 / 2 = 2,94 \text{mq}$
	$(2,85 + 3,32) \times 2,46 / 2 = 7,79 \text{mq}$
	38,06mq
	$2,30 \times 0,92 / 2 = 1,06 \text{mq}$
	$0,92 \times 1,65 = 1,52 \text{mq}$
	$(0,92 + 1,24) \times 2,30 / 2 = 2,48 \text{mq}$
	$(1,24 + 2,12) \times 2,21 / 2 = 3,71 \text{mq}$
	$(2,12 + 2,58) \times 2,65 / 2 = 6,23 \text{mq}$
	$(2,58 + 2,73) \times 1,45 / 2 = 3,85 \text{mq}$
	18,85mq
	$20,40 \times 10,00 = 24,00 \text{mq}$
	$12,43 \times 1,20 = 14,91 \text{mq}$
	$1,20 \times 0,44 / 2 = 0,26 \text{mq}$
	15,17mq

altra
proprietà

**EDIFICIO
ESISTENTE**